

WELL SCHEDULE
GEOLOGICAL SURVEY

U. S. DEPT. OF THE INTERIOR

MAR 18 1974

MASTER CARD

[Handwritten signature]
DEC 16 1974

Record by WTO Source of data Bowc Date 6/13 Obs driller 5-3-73 Map CARRIERE QUAD.

State Miss County (or town) Pearl River 28 55

Latitude: 30° 33' 20" N Longitude: 089° 39' 42" W Sequential number: 1

Lat-long accuracy: 2 T. 6 N. 17 E. Sec. 1 SW NW

Local well number: W123CB0106517W Other number: B & M

Local use: 074107 Owner or name: MILLBROOK CC

Owner or name: MILLBROOK CC Address: _____

Ownership: County, Fed Gov't, City, Corp or Co, Private, State Agency, Water Dist _____ P

Use of water: (A) Air cond, Bottling, Comm, Dewater, Power, Fire, Dom, Irr, Med, Ind, P S, Rec, (S) Stock, Instit, Unused, Repressure, Recharge, Desal-P S, Desal-other, Other Fills pond I

Use of well: (A) Anode, Drain, Seismic, Heat Res, Obs, Oil-gas, Recharge, Test, Unused, Withdraw, Waste, Destroyed. W

DATA AVAILABLE: Well data Freq. W/L meas.: _____ Field aquifer char.

Hyd. lab. data: _____

Qual. water data; type: _____

Freq. sampling: _____ Pumpage inventory: yes, no, period: _____

Aperture cards: _____ yes

Log data: 4' 1126' DE

WELL-DESCRIPTION CARD

SAME AS ON MASTER CARD Depth well: _____ ft 1134 Meas. rept accuracy 3

Depth cased: _____ ft 1114 Casing type: _____ Diam. in 2

Finish: (C) porous concrete, (F) gravel w. (perf.), (G) gravel w. (screen), (H) horiz. gallery, (O) open end, (P) perf., (S) screen, (T) sd. pt., (W) shored, (X) open hole, (Z) other S

Method Drilled: (A) rot, (B) bored, (C) cable, (D) dug, (H) hyd jetted, (J) air percuss, (P) air percuss, (R) reverse, (T) trenching, (V) driven, (W) drive wash, (Z) other H

Date Drilled: 5-3-73 973 Pump intake setting: _____ ft _____

Driller: LUMPKIN WELL DRLG. CARRIERE

Lift (type): (A) air, (B) bucket, (C) cent, (J) multiple, (L) multiple, (M) multiple, (N) none, (P) piston, (R) rot, (S) submerg, (T) turb, (Z) other N Deep Shallow

Power (type): (nat) diesel, elec, gas, gasoline, hand, gas, wind; (LP) H.P. Trans. or meter no. _____

Descrip. MP _____ above _____ ft below LSD, Alt. MP _____

Alt. LSD: _____ 90 Accuracy: (source) topo 4

Water Level: _____ ft above _____ ft below MP; Ft below LSD 0 Accuracy: _____ D

Date meas: 573 Yield: _____ gpm _____ Method determined _____

Drawdown: _____ ft _____ Accuracy: _____ Pumping period _____ hrs _____

QUALITY OF WATER DATA: Iron _____ ppm Sulfate _____ ppm Chloride _____ ppm Hard. _____ ppm

Sp. Conduct _____ K x 10⁶ _____ Temp. _____ °F Date sampled _____

Taste, color, etc. _____

Well No.

Well No. _____

Latitude-longitude _____
N
S
d m s d m s

LOGIC CARD

SAME AS ON MASTER CARD Physiographic Province: 03 Section: _____

Drainage Basin: D Subbasin: 13V

Topo of well site: (D) depression, stream channel, dunes, flat, hilltop, sink, swamp, (C) offshore, pediment, hillside, terrace, undulating, valley flat
(E) (F) (H) (K) (L) (P) (S) (T) (U) (V)

MAJOR AQUIFER: system _____ series TM aquifer, formation, group MZ

Lithology: US Origin: 3 Aquifer Thickness: 165+ ft

Length of well open to: _____ ft 20 Depth to top of: _____ ft 960

MINOR AQUIFER: system _____ series _____ aquifer, formation, group _____

Lithology: _____ Origin: _____ Aquifer Thickness: _____ ft

Length of well open to: _____ ft _____ Depth to top of: _____ ft _____

Intervals Screened: _____

Depth to consolidated rock: _____ ft _____ Source of data: _____

Depth to basement: _____ ft _____ Source of data: _____

Surficial material: _____ Infiltration characteristics: _____

Coefficient Trans: _____ gpd/ft _____ Coefficient Storage: _____

Coefficient Perm: _____ gpd/ft²; Spec cap: _____ gpm/ft; Number of geologic cards: _____

Lumpkin
P.O. Box 8
PARRISKE

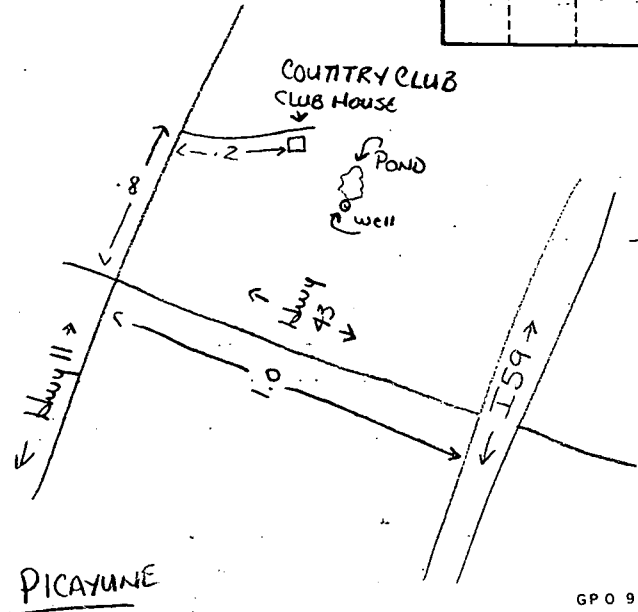
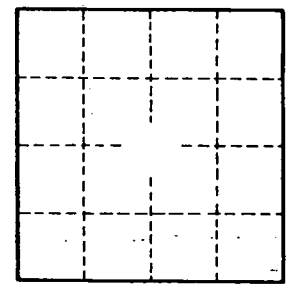

Well No. _____